

# Instruction for use



IMM1016\_IFU.Version6.2018-11-01



Butterfly

**immedia**  
a part of Etac

# Illustrations

ILL.

GB

SV

NO

DA

FI

DE

NL

FR

IT

ES

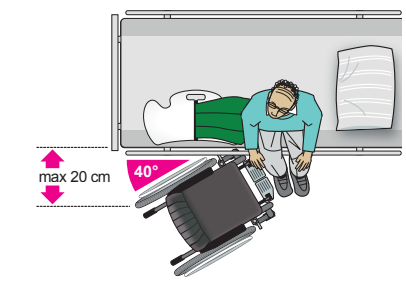

1

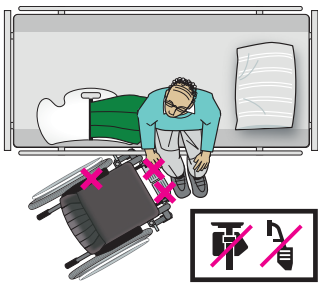

2

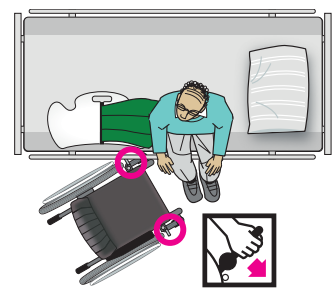

3

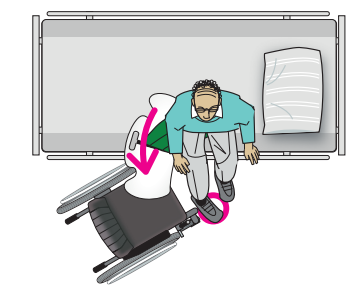

4

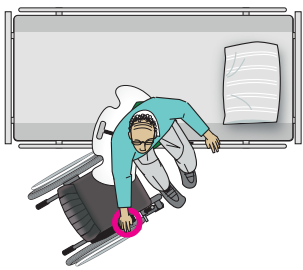

5

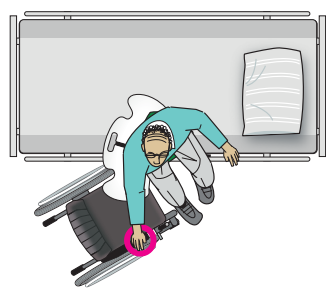

6

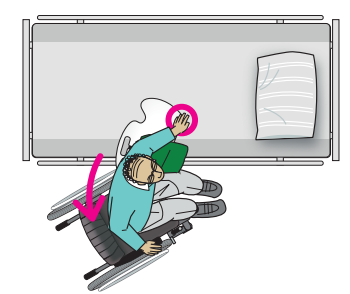

7

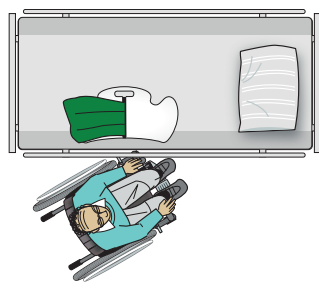

8

# General

## Thank you for choosing an Etac product.

To avoid accidents and injury when moving and handling the products, read the manual carefully.

The person described as “the user” in this user manual is the person who is lying or sitting on the product. The carers are the people who manoeuvre the product.



**This symbol appears alongside the text in the manual. It draws the reader’s attention to points at which there may be a risk to the health and safety of the user or carer.**

The products comply with the standards applicable for Class 1 products in the European Council Directive MDD 93/42/EEC on medical devices.

At Etac we strive to improve our products all the time and therefore we reserve the right to make changes to products without prior warning. All measurements given on illustrations

and similar material are for guidance only and Etac cannot be held liable for errors and defects.

The information given in this manual, including recommendations, combinations and sizing, does not apply to special orders and modifications. If the customer makes adjustments, repairs or combinations not predetermined by Etac, the Etac CE certification and Etac warranty will not be valid. If in doubt, please contact Etac.

Warranty: Two-year warranty on material and manufacturing defects, provided that the product is used correctly.

For further information on the Etac transfer range, see [www.etac.com](http://www.etac.com).

The product can be scrapped in accordance with national regulations.

## Symbols in general



Washing



pH level



Read the user manual



User mass limit = maximum rated load



Do not bleach



Wipe off



Warning



The product can be scrapped according to national regulations



Tumbledry



Never leave on the floor



Production year, month and day



Manufacturer  
Class 1 - European Council Directive MDD 93/42/EEC on medical devices



Iron



Risk of sliding down



Batch no./Lot no.



Do not dryclean



Keep out of the sun

## Intended use

Butterfly is a unique glide board for use in manually handling a user with good seated balance in the seated position. The glide board can be used with or without glide wings.

## Intended environment

Acute care, Long-term care, Home care.

# Practical handling

## Positioning

When moving a user from bed to chair or other seat, position the wheelchair at an angle of 40° from the bed. Distance between two supporting surfaces must not exceed 25 cm (Illustration 1). The black surfaces under the Butterfly Board must be supported.

Position the glide board so that the cutout rests firmly against the wheelchair wheel. The other side must be positioned on e.g. the bed next to the user's thigh (Illustration 4). Remember to apply brakes to lock wheelchair and bed (Illustration 2 + 3).

## Use

### To use with glide wings

Fitting the glide wings:

If using glide wings, position these over the Butterfly Board so that they are flush with the cutout on the glide board. Push the Velcro tapes to the back (and feed through the handle). The tape is flush with both cutouts. Turn the Butterfly Board and fasten the Velcro tape.

The user leans away from the direction of movement and either the carer or the user him/herself pushes a small part of the glide wing under the user's buttock/thigh (Illustration 4). The user now leans in the direction of movement. Pushing him/herself away from the mattress, the user now glides slowly over to the wheelchair (Illustration 5 + 6 + 7). Depending on how self-supportive the user is, the carer can help the user either by supporting the upper body with SupportBelt or completing the move using a Sling.

### To use without glide wings:

The user can slide slowly or "shuffle" over to the wheelchair by pushing him/herself away from the mattress (Illustration 5 + 6 + 7).

Depending on how self-supportive the user is, the carer can help the user either by supporting the upper body with SupportBelt or using a Sling, MultiGlide, towel or similar to complete the manual handling.

## Tips

If an angle is created (e.g. if the bed is slightly higher than the wheelchair), the user will slide more easily from one to the other.

To prevent strain on the knees in connection with the above, it may be beneficial to use a PediTurn turnplate and SupportBelt,

so that the user does not twist at the knee and the carer has a good grip on the user.

To remove Butterfly, the user moves his/her weight from the glide board, lifts and then pulls it free.

# Notice

## Special features

Always check the product before use and after washing.

Never use a defective product. If the product shows signs of wear-and-tear, it must be scrapped.

Read these instructions carefully.

It is important that carers receive instruction in manual handling. Etac offers advice and training for carers. For further information, contact Etac.

Always use the correct manual handling techniques.

Encourage the user to assist where possible.

To ensure that the user feels safe and that every manual handling is smooth, always plan the manual handling in advance.



There is a risk that the user may slide off. Never leave the user alone on the edge of the bed.



Never leave the product on the floor



Always conduct a risk assessment, and ensure that the assistive product can be used for the individual user and, in combination with other devices, that it is safe for the user and carers.



Never use Butterfly under wet conditions as the underside of the board may become slippery in contact with water.



Remember to apply brakes to lock bed and wheelchair.

If in any doubt - please contact Etac.

## Material and cleaning

### Material:

Butterfly Board:  
Fibreglass.

Butterfly GlideWings:

Outer surface: Nylon  
Inner surface: Nylon  
Filling: Polyester.

The product should be checked regularly, preferably each time it is used, and especially after washing.

Check that there is no damage to seams or fabric.



**Never try to repair a product yourself.**  
**Never use a defective product.**

### Washing instructions:

During washing the Velcro must be assembled.

Butterfly Board:

Can be wiped with soapy water or disinfectant.

Butterfly GlideWings:

Do not use fabric softener – this will reduce the glide effect.

This product can be cleaned with a solvent-free cleaning agent with a pH level between 5 and 9, or a 70% disinfection solution.



## Products and accessories

Article no.	Product Description	Size (mm)
IM401	Butterfly Board	W320xL660
IM4001	Butterfly GlideWing L	W350xL400
IM4002	Butterfly GlideWing XL	W350xL475

## Combinations

Article no.	Product Description	Size (mm)
IM99836GT	PediTurn Soft	Ø400
IM99700	PediTurn Hard	Ø380
IM8017015	SupportBelt XL	1300-1700
IM8015013	SupportBelt L	1200-1500
IM8013013	SupportBelt M	900-1300
IM8010513	SupportBelt S	650-1050
IM8010509	SupportBelt XS	650-1050
IM8009009	SupportBelt XXS	450-900
IM428	Sling - long	W160xL1900
IM428K	Sling - short	W160xL1200
IM426	SmartMove w/4 handles	W210xL600

ILL.

GB

SV

NO

DA

FI

DE

NL

FR

IT

ES

# Service information

## Inspection

**Thank you for choosing an Etac product.** If the customer makes adjustments, repairs or uses combinations not predetermined by Etac, the Etac CE certification and Etac warranty will not be valid.

**Warranty:** Two-year warranty on material and manufacturing defects, provided that the product is used correctly. Before taking a product into service always conduct a risk assessment according to national and/or local legislation.

### First inspection:

- Is the packaging intact?
- Read the label on the packaging and check the article no. and product description.
- Check that Short Instruction is enclosed – updated User Manual/Instruction for use can be downloaded from [www.etac.com](http://www.etac.com) or contact Etac Customer Service or your local distributor.

- Check the label on the product - does it include article no., product description, lot/batch no., cleaning instructions and supplier name?

### Periodic Inspection:

- Make sure that your Manual transfer system is always in perfect condition.
- After wash – always check materials, stitching, handles, buckles.
- If the product shows signs of wear and tear, it must be removed from service immediately.



#### Visual inspection/Check the product:

Ensure that the materials, seams, stitching, handles, buckles are intact/faultless.



#### Stability test:

Try to bend the product and verify that it feels firm, stable and solid.



#### Mechanical load or stress/Test handles:

Pull hard on the handles in opposite directions and check the material, seams and stitching.

#### Test buckles:

Lock the buckle and pull in opposite directions, check the buckle and the stitching.



#### Test low/high friction:

Place the product on a firm surface or a bed, place your hands on the material and test the friction by pushing your hands down into the product.

Low friction – slides effortlessly

High friction – no sliding/movement

## Check

### Manual transfer aids with handles, straps and buckles:



### Manual transfer aids for sitting and lying transfer:



### Manual transfer aids with high or low friction:



The product can be scrapped in accordance with national regulations



Read the User Manual

If in doubt, please contact Etac Customer Service or local distributor for more information and guidance.

For more information about training and the use of these products, contact the Etac transfer experts – [www.etac.com](http://www.etac.com).



Class 1 - European Council  
Directive MDD 93/42/EEC  
on medical devices