

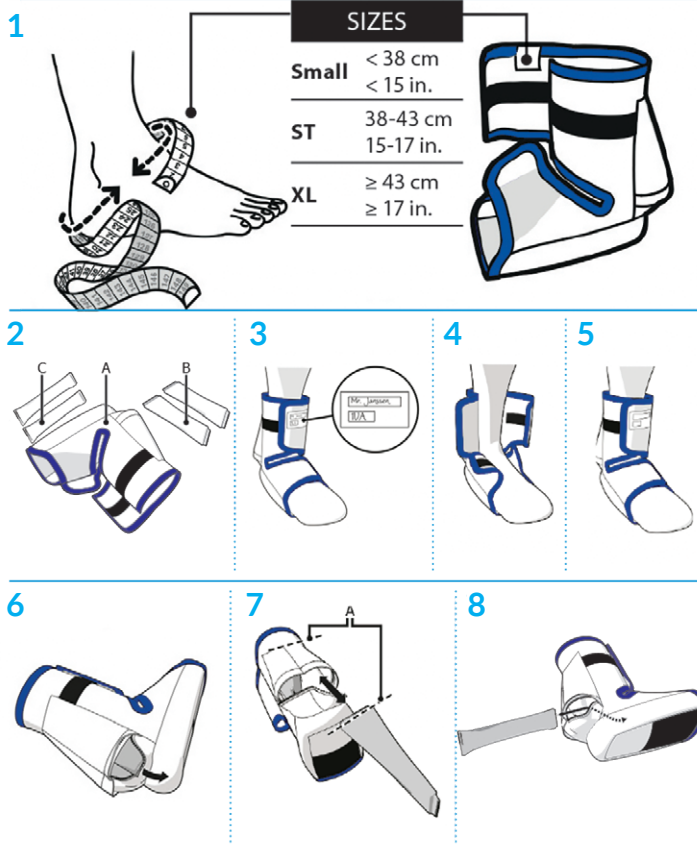

Maxxcare®



Purpose of use

The Maxxcare Heel Pro Evolution is used to offload pressure on the heel and ankle. The Heel Pro Evolution contains four removable air-tubes that offer protection against pressure. The extremely smooth exterior offers protection against shear forces and friction. The Heel Pro Evolution can be used while lying down and sitting. Walking a short distance indoors, for instance from bed to bathroom, is possible as the non-skid material on the bottom reduces the risk of sliding. Take care not to load the heel while walking, as the exterior fabric around the heel is very slippery.

Use the Heel Pro Evolution:

- > To prevent heel- and/or ankle ulcers for patients with an increased risk of developing sores due to pressure or shear.
- > As an additional therapeutic measure for patients with existing decubitus of the heel.
- > To reduce heel pain during prolonged periods of bed rest.
- > To prevent footdrop.

This manual is meant for the Heel Pro Evolution user and for the healthcare professional working with the Heel Pro Evolution. Be sure to read and understand this manual completely and safely store the manual for later reference!

For more information or requests for manuals, contact Morton & Perry.

Product specifications – Pic. 2

- A. Maxxcare Heel Pro Evolution - B. Air tube large (2x) - C. Air tube small (2x)

Precaution and safety instructions

WARNING!

- > The heel-exterior of the Heel Pro Evolution is very slippery. Do not load the heel when you stand up or while you walk!
- > Do not wear the Heel Pro Evolution while walking up- or downstairs!
- > The Heel Pro Evolution is for single patient use only! The product may only be used by the person whose name is written on the label.
- > Never use a damaged product! When the product is damaged, contact your supplier.
- > The Heel Pro Evolution should only be used for the purposes described in this manual. Maxxcare BV cannot be held responsible for any damage caused by abnormal use, improper use or negligence.
- > To prevent damage: Do not use or leave this product close to high temperature heat sources, naked flames or sharp objects.

Instructions for use

WARNING: Do not fasten too tightly. This may cause a reduction of blood flow and/or discomfort.

1. Check if the size of the Heel Pro Evolution is correct. (Pic. 1).
2. Check the Heel Pro Evolution regularly for deflated air tubes, broken seams and other damages.
3. Write patient's name on label. (Pic. 3)
4. Open Velcro straps. (Pic. 4)
5. Place patient's foot into the Heel Pro Evolution.
6. Loosely fasten Velcro straps. (Pic. 5)

Maintenance

Washing instructions: see care label.

Tip: The Heel Pro Evolution can be washed without removing the air tubes. PLEASE NOTE: Air dry the Heel Pro Evolution. Only use when the product is completely dry.

Follow underneath instructions when incidentally removing and placing the air tubes.

1. Open the Velcro at the rear side of the Heel Pro Evolution. (Pic. 6)
2. Remove the large air tubes (Pic. 7) or small air tubes (Pic. 8).
3. Put all air tubes back in place before using the Heel Pro Evolution. PLEASE NOTE: When inserting, make sure that the top of the large airtubes is laid flat against the back of the Heel Pro Evolution. See A (Pic. 7).

Warranty

Maxxcare offers a limited warranty against defects in workmanship and material for a period of six (6) months after the original date of purchase, provided the product has been used normally. Any damage arising from abnormal use, or caused by improper handling, cleaning or negligence, is excluded from this warranty.